

FNCLO

HIDE IT WITH STYLE

Box Contents

EC18020 / EC18021

VINYL PARTS

A

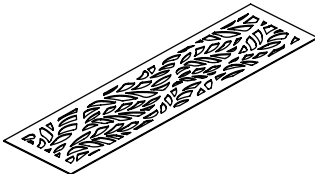

Lasercut Panel (2)
1/8" x 9 1/8" x 36"

B

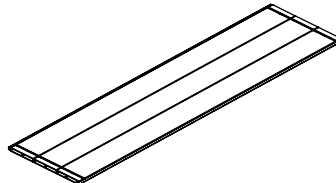

Wide Board (8)
3/8" x 8 1/2" x 36"

C

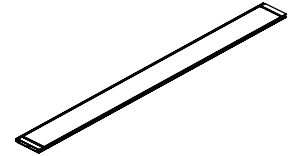

Thin Board (2)
3/8" x 3" x 36"

ALUMINUM PARTS

D

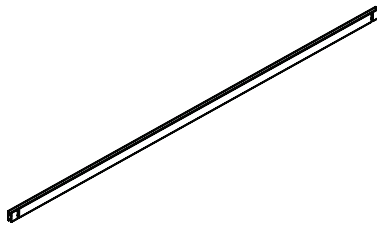
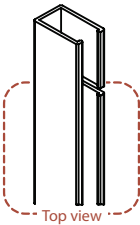

Upper Rail (2)
3/8" x 1/2" x 36"

E

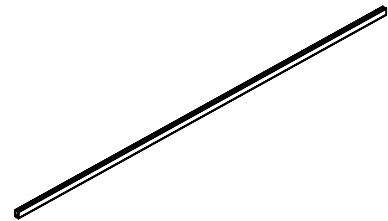
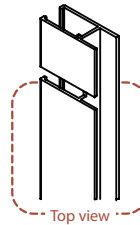

Lower Rail (2)
3/8" x 3/4" x 36"

F

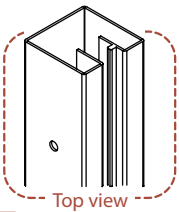

Left Post (2)
1 1/8" x 1 1/8" x 48"

G

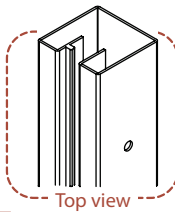

Right Post (2)
1 1/8" x 1 1/8" x 48"

H



Ground Stake (4)
1" x 1" x 16"

SMALL PARTS

I

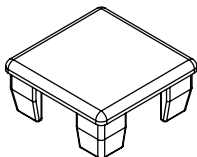

Post Cap (4)

J

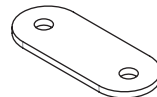

Joiner Clip (4)
1/16" x 3/8" x 1"

SCREWS

K



3/4" Self-Drilling Stainless Steel Screw (16)